

FRIALEN® Electrofusion Reducers MR

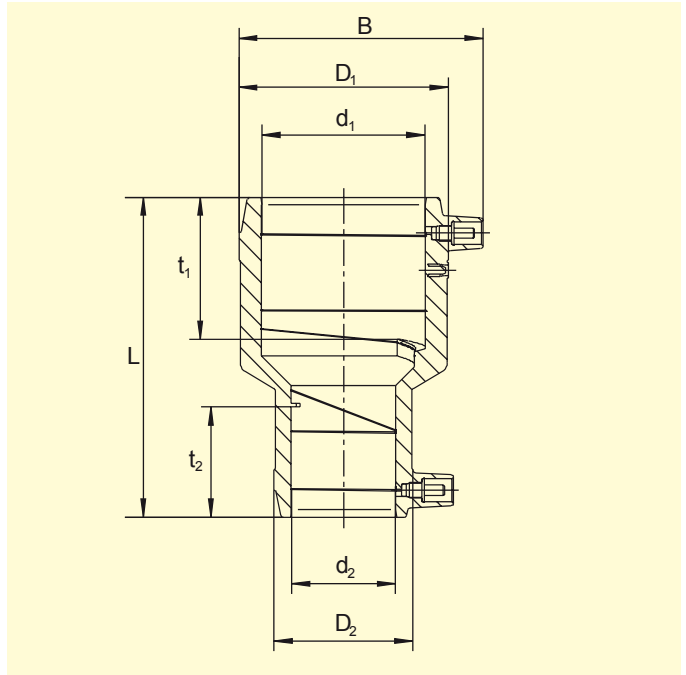

PE 100 SDR 11

Maximum working pressure 16 bar (water)/10 bar (gas)



d_1	d_2	Order Ref.	Stock-status	BX	PU	L	t_1	t_2	D_1/D_2	B	Weight kg/each
32	20	615386	1	80	2560	88	39	30	45/ 32	62	0,060
32	25	615502	1	70	2240	88	39	33	45/ 38	62	0,060
40	20	615387	1	60	1920	98	43	30	54/ 32	70	0,080
40	32	615388	1	50	1600	98	43	39	54/ 45	70	0,090
50	20	612069	2	32	1024	110	49	37	68/ 32	82	0,130
50	32	612070	1	32	1024	110	49	39	68/ 45	82	0,140
50	40	612071	1	25	800	110	49	43	68/ 54	82	0,140
63	32	615389	1	18	576	125	55	44	82/ 45	96	0,220
63	40	615390	1	16	512	125	55	43	82/ 54	96	0,220
63	50	612072	1	16	512	125	55	48	82/ 68	96	0,240
90	50	615391	1	15	270	160	69	49	117/ 68	129	0,490
90	63	615392	1	15	270	160	69	55	117/ 82	129	0,510
110	63	615393	1	10	180	160	79	55	142/ 82	152	0,730
110	90	615693	1	8	144	180	79	69	140/115	152	0,900
125	90	615694	1	8	144	200	86	69	155/115	166	0,980
160	110	615695	1	8	64	230	98	79	201/140	207	1,990
225	160	616356	1	1	36	270	110	98	282/203	283	4,800

FRIALEN safety fittings can be fused to pipes SDR11 - SDR 17.6, minimum wall thickness $s_{min} \geq 3$ mm. Other SDR-stages on request. Please observe the marking directly at the product, which is mandatory.
DVGW-Registration Nos. DV-8601AU2248 and DV-8606AU2249

Please turn over for important information regarding application of our products.

FRIALEN® Electrofusion Reducers MR

Areas of Application

The FRIALEN Electrofusion Reducer MR is applied for immediate pipe reduction within the pipe system.

Assembly Instructions

Fusing of pipe ends with the FRIALEN Electrofusion Reducers MR takes place by FRIALEN fusion – leak-proof and longitudinally strong.

The pipe ends are prepared according to the general installation instructions (note “Assembly Instructions” for FRIALEN Safety Fittings for house connections and distribution pipes (Remove oxide skin/clean).

Eleven good reasons for using the FRIALEN Electrofusion Reducers MR:

- Large coupler depth for ease of pipe guiding (no holding clamps required)
- Extra wide fusion zones
- Maximum stability through great wall thickness
- Cold zones at the front side and in the middle of the coupler
- Exposed heating coil for direct heat transmission to the pipe
- Small annular gap for build-up of optimum joining pressure in the fusion zone
- Touch proof electric contacts
- Fusion indicator for visual fusion control
- Durable batch marking
- Individually wrapped for dirt protection
- Additional barcode for tracing back the underground fitting (Traceability-Coding)

For further information, please call our customer service staff and specialist advisers.

FRIATEC Aktiengesellschaft · Technical Plastics Division
 P.O.B. 71 02 61 · D-68222 Mannheim
 Telephone +49 621 486-1431 · Telefax +49 621 479196
 www.friatec.com · E-Mail: info-frialen@friatec.de

Please find our datasheets for downloading on the internet at www.friatec.com