

FRIALEN® Couplers with removable stop MB

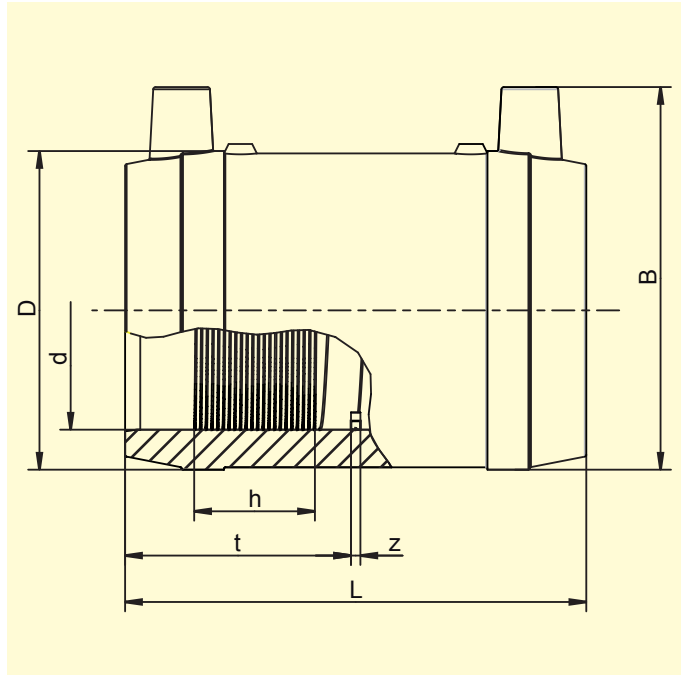

PE 100 SDR 11

Maximum working pressure 16 bar (water)/10 bar (gas)



d	Order Ref.	Stock-status	BX	PU	D	L	t	z	h	B	Weight kg/each
20	612680	1	110	3520	33	60	29	2	17	49	0,040
25	612681	1	120	3840	38	66	32	2	18	55	0,050
32	612682	1	60	1920	45	78	38	2	21	61	0,064
40	612683	1	40	1280	54	85	42	2	23	71	0,100
50	612684	1	25	800	68	98	48	2	27	82	0,150
63	612685	1	15	480	82	110	55	2	29	96	0,221
75	612686	1	50	400	98	122	60	3	24	110	0,320
90	612687	1	30	240	114	138	68	3	41	130	0,440
110	612688	1	24	192	137	159	78	3	48	152	0,710
125	612689	1	16	128	156	172	85	3	51	169	0,950
140	612690	1	12	96	174	184	91	3	52	185	1,270
160	612691	1	8	64	199	190	94	3	52	207	1,770

FRIALEN safety fittings can be fused to pipes SDR11 - SDR 17.6, minimum wall thickness $s_{min} \geq 3$ mm. Other SDR-stages on request. Please observe the marking directly at the product, which is mandatory.
DVGW-Registration Nos. DV-8601AU2248 and DV-8606AU2249

FRIALEN® Couplers with removable stop MB

Areas of Application

The FRIALEN-coupler MB is used for pipe connections when laying long runs. Additional areas of application:

- Integration of adapters into an existing pipe-line
- Connection of pipelines with fixed or restraint points
- Reinforcement / sealing of localised pipe damage
- Reinforcement of pinch points

Assembly Instructions

The fusion of pipe ends with the FRIALEN-coupler MB takes place using FRIALEN-fusing – leakproof and longitudinally strong.

The pipe ends are prepared according to the general installation instructions (see “Assembly Instructions” for “FRIALEN-Safety Fittings for house connections and distribution pipes up to d 225”). This involves removing the oxide skin and cleaning the pipe ends. Please note that spigot of valves must be at least half as long as the coupler.

Eleven good reasons for using the FRIALEN-Coupler MB:

- Large coupler depth for ease of pipe guiding (no holding clamps required)
- Extra wide fusion zones
- Maximum stability through great wall thickness
- Cold zones at the front side and in the middle of the coupler
- Exposed heating coil for direct heat transmission to the pipe
- Small annular gap for build-up of optimum joining pressure in the fusion zone
- Touch proof electric contacts
- Fusion indicator for visual fusion control
- Durable batch marking
- Individually wrapped for dirt protection
- Additional barcode for tracing back the fitting (Traceability-Coding)

For further information, please call our customer service staff and specialist advisers.

FRIATEC Aktiengesellschaft · Technical Plastics Division
 P.O.B. 71 02 61 · D-68222 Mannheim
 Telephone +49 621 486-1431 · Telefax +49 621 479196
 www.friatec.com · E-Mail: info-frialen@friatec.de

Please find our datasheets for downloading on the internet at www.friatec.com